

Product Datasheet

TaiyTech®

15W

3.3V to 48V 3A to 850mA

EU

Switching Power Supply

INPUT	VOLTAGE / FREQ.	100~240Vac/ 50/60Hz ±3Hz
	RATED INPUT CURRENT	0.5A max.
	INPUT POWER	24W max.
	POWER CONSUMPTION (no load)	0.3W max.
	INRUSH CURRENT (Typ.)cold Start)	55A/230Vac.
	CONFIGURATION	EN50075 (BS/NE/AS/NZ optional)
OUTPUT	DC VOLTAGE	3.3V ~ 48V
	RATED CURRENT (max OUTPUT)	3A ~ 850mA
	CONSTANT CURRENT	No
	CONSTANT VOLTAGE	Yes
	LEAKAGE CURRENT	50µA max.
	RATED OUTPUT POWER	18W max.
	LINE REGULATION (in % of V_{in})	±5% of rated output voltage
	RIPPLE AND NOISE	150Vp-p max.
	AVERAGE EFFICIENCY	meets EuP2011 on all rated outputs
	TURN ON DELAY TIME	2000mS at nominal input
	RISE TIME	≤ 20mS
	HOLD UP TIME	8nS min.
	DC-CORD AND PLUG	On request
PROTECTION	OVER VOLTAGE PROTECTION	Max. 140% of rated output voltage
	SHORT CIRCUIT PROTECTION	Hiccup Mode; Autorecovery
	OVER CURRENT PROTECTION	Max. 150% of rated output current
ENVIRONMENT	TEMPERATURE (working/storage)	0°C ~ +40°C / -20°C ~ +80°C
		EuP 2011 compliant
		PAH/6P/NP/REACH compliant
		ENERGY STAR Level V
SAFETY &	EN60950-1, EN60065, EN60335-1	
EMC	EN55013, EN55014, EN55020, EN55022, EN55024, EN61000-3-2/3	
MTBF	50K hours min. MIL-HDBK-217F(25°C)	
OTHERS	DIMENSION	79*32*86.5mm(L*W*H)
	NET WEIGHT	115g
	PACKING	100pcs/13.5kgs/0.055CBM

TYPICAL APPLICATIONS:

Router
Set Top Box
Testing and Measuring Equipment

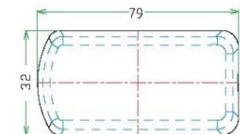
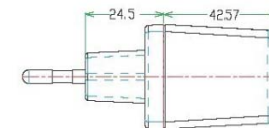
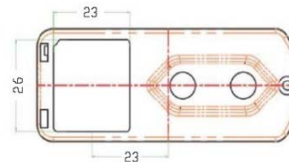

Dimension are advisory only. This datasheet is covering a complete product family. All ratings shown are reflecting smallest and largest values only. For detailed ratings, please request an individual datasheet for the power supply you require. Appearance may vary, alternation reserved without prior notice.

! taiyie
Taiyie Technology